



TROLLEY

OPERATING INSTRUCTIONS



WWW.DELTAHOIST.COM

I. ASSEMBLY of  DELTA GREEN® TROLLEY

1. Measure the actual width of the runway beam;
2. Assemble the required number of spacer washers equally to the inside of the DELTA GREEN® trolley side plates so that the dimension between trolley wheel flanges is 6mm of 1/4(Max) greater than the Runway Beam width.
3. Assemble the remaining washers outside the DELTA GREEN® trolley side plate and fit nuts to hanger pin. There must always be at least one washer on the side and the outside of each DELTA GREEN® trolley side place (See diagram N).
4. Slacken off the hanger pin nuts & spread the side plates so that the wheels can be slip peed up over the runway beam. Screw the nuts firmly against the washers, then suspend a light load from the trolley to ensure that all four wheels contact the runway beam. Screw the Nuts tightly against the Washers then secure with lockouts.
5. DELTA GREEN® trolley when assembled at the minimum beam width, will require hanger pin to be offset, so it will not foul the hand wheel.
6. Suspend the maximum safe working load on the DELTA GREEN® trolley then run the unit slowly along the full length of the Runway to ensure satisfactory operation.

II. Periodical-check and maintenance

DELTA GREEN® Trolley requires minimum maintenance depending on the usage. A professional check up and test per year is required.

II. **DELTA GREEN® TROLLEY TECHNICAL SPECIFICATIONS**

1. PLAIN TROLLEY SERIES SPECIFICATIONS

Capacity	I-Beam Width	N.W./KGS	A	B	C	H
0.5t	64-140	7	230	212	198.5	113
1.5t	64-140	12	254	255	231.5	128
1t	64-140	18	276	277	265	145
2t	76-165	22	294	302	278	152
3t	76-203	30	344	344	338	186
5t	88-203	55	360	378	393	219
10t	125-203	93	403	455	490	275.5
20t	136-203	235	475	642	622	315
30t	144-175		517	642	557	245

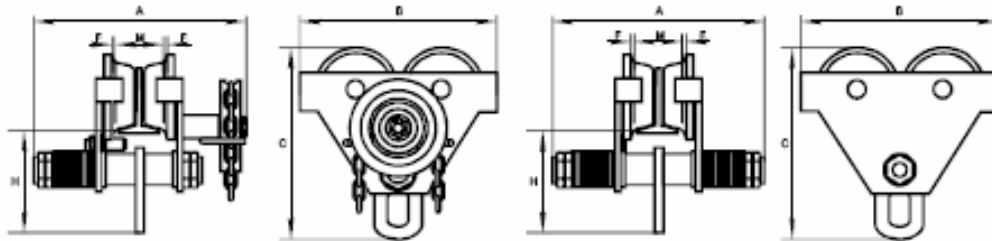

GEARED TROLLEY

PLAIN TROLLEY

2. GEARED TROLLEY SERIES SPECIFICATIONS

Capacity	I-Beam Width	N.W./KGS	A	B	C	H
0.5t	64-140	14	308.5	212	198.5	113
1t	64-140	19	328.5	255	231.5	128
2t	76-165	29	361.5	302	278	152
3t	76-203	40	428.5	344	338	186
5t	88-203	65	434	378	393	219
10t	125-203	103	487.5	455	490	275.5
20t	136-203	245	547	642	622	315
30t	144-175		517	642	557	320

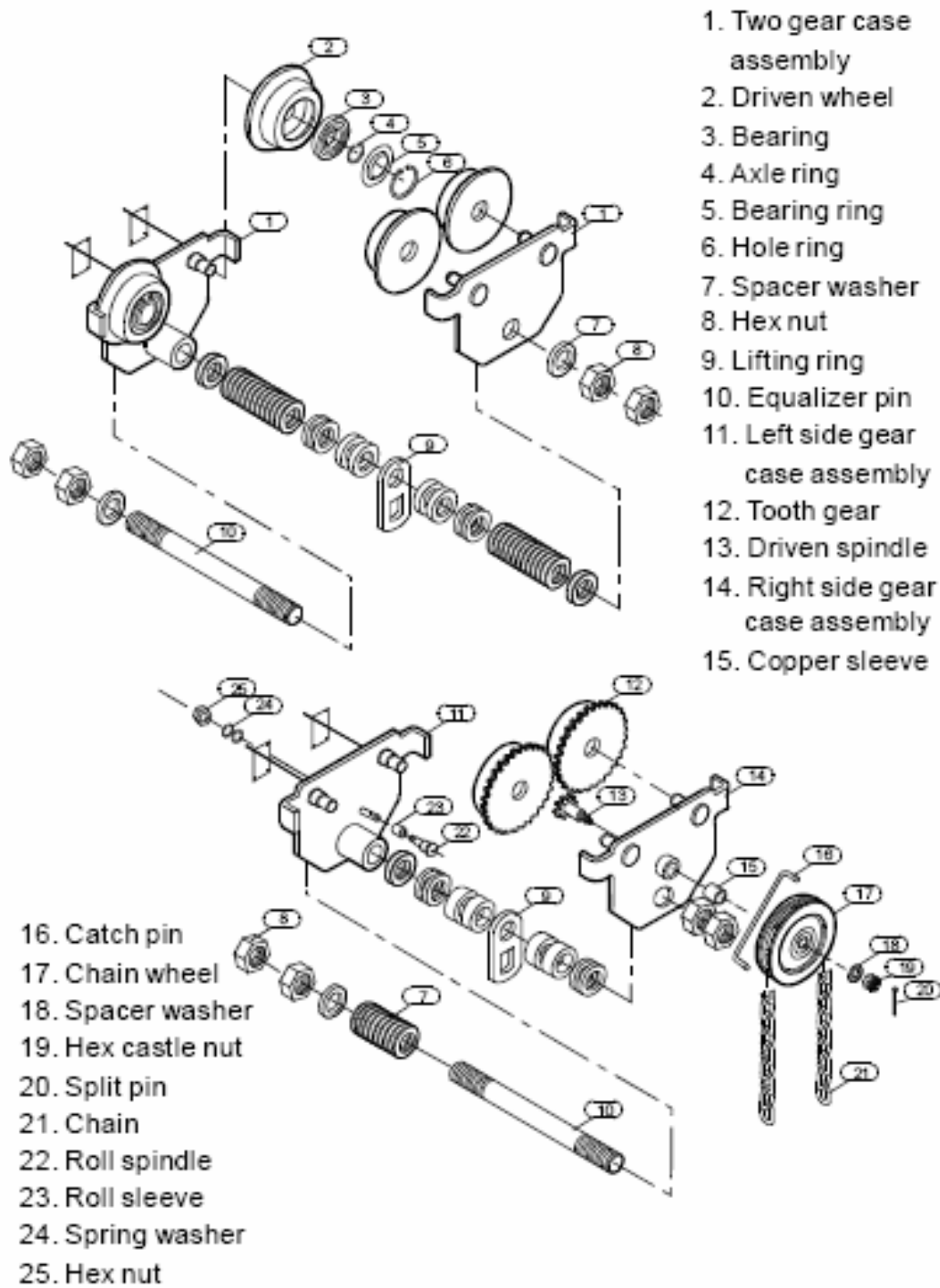

1. Two gear case assembly
2. Driven wheel
3. Bearing
4. Axle ring
5. Bearing ring
6. Hole ring
7. Spacer washer
8. Hex nut
9. Lifting ring
10. Equalizer pin
11. Left side gear case assembly
12. Tooth gear
13. Driven spindle
14. Right side gear case assembly
15. Copper sleeve

16. Catch pin
17. Chain wheel
18. Spacer washer
19. Hex castle nut
20. Split pin
21. Chain
22. Roll spindle
23. Roll sleeve
24. Spring washer
25. Hex nut